

GCC[®]

Economic Double Action

Floor Spring

GTS 650



Technical Data

Code No.	1	2
Spring strength/Closing force in Nm, approx.	15	20

Closing ranges

Two closing speed variable by valve adjustment provide full hydraulic control

Valve 1: 130°-20° closing speed.

Valve 2: 20°-0° latching range.

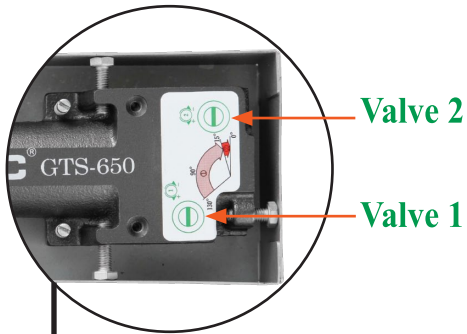

Two Adjustment Screw

One for Closing Speed and the other for Latching Speed.

Special Retaining Rings

Prevent the Adjusting Screws from falling out of the Closer Body, which is the main cause of closer failure.

Functions: HO & NHO

Code No.:

60= 90° Hold open & 130° Back stop(standard)

70= 105° Hold open & 130° Back stop(optional)

62=Non-Hold open & 130° Back stop(optional)

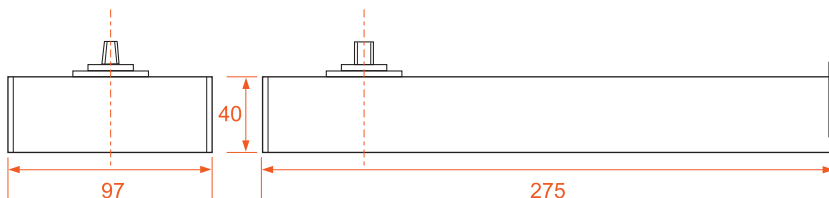
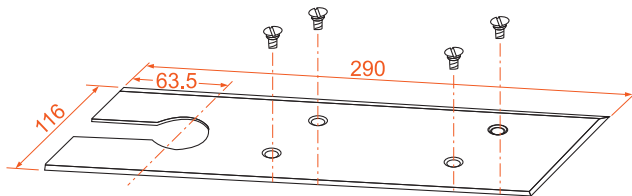

Cement case size: L: 275mm W: 97mm H: 40mm

Specifications:

Maximum Door Width: 37"(950mm)

Maximum Door Weight: 80kgs(176lbs.)

- 1 First adjusting closing range 130°-20°
- 2 Second adjusting latching range from approx 20°-0°
- 3 Hold open at 90°(standard)
- 4 Hold open at 105°(optional)
- 5 Back stop at 130°(standard)
- 6 NHO: Non hold open (optional)

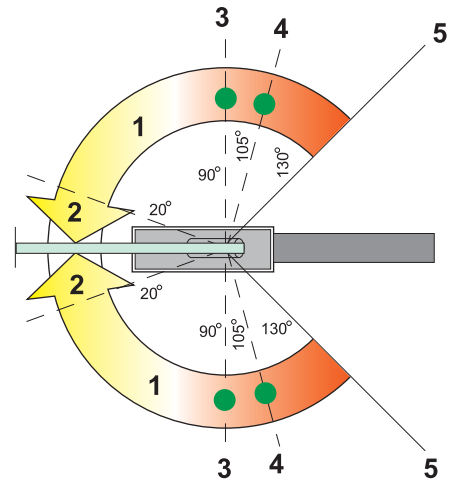

Cover plate available in:

SSS: Satin Polished Stainless Steel.

TP : Satin Polished Stainless Steel with Titanium Plated(PVD Coated)

Adjustable Body

* Adjustment in cement case for height 3mm, width 10mm and length 7mm.

* Horizontal & Vertical adjustable.

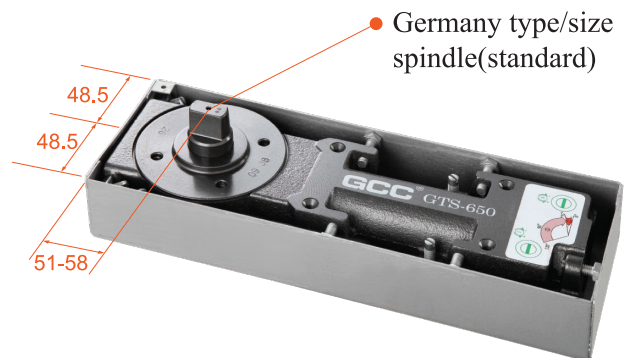

• Italy type/size spindle available by order.

Accessories

9116/7
Adjustable top centre with ϕ 12.5mm pin

9116

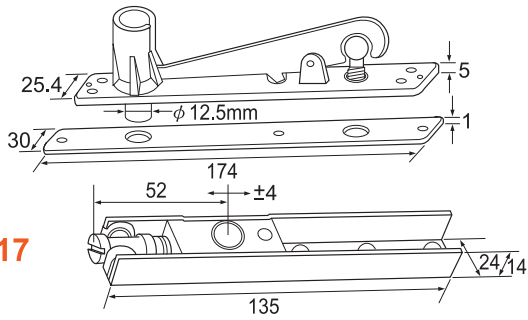

9117

9118/9
Adjustable top centre with ϕ 15mm pin

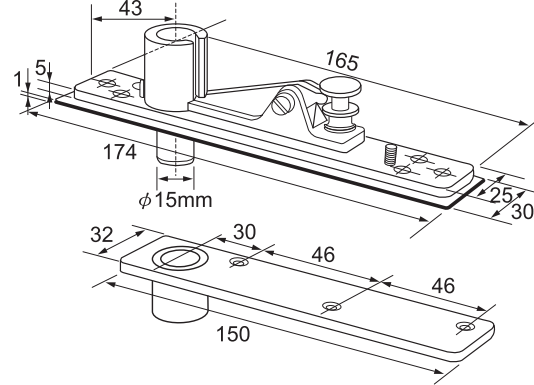

9118

9119

9120/1
Adjustable top centre with ϕ 15mm pin

9120

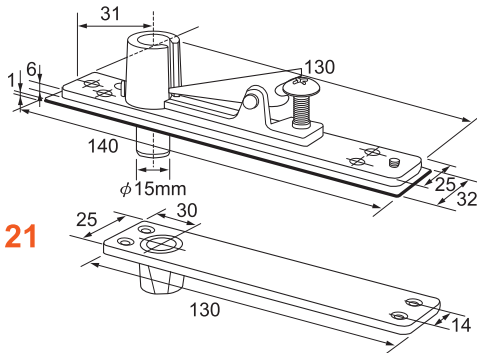

9121

9123 Door strap

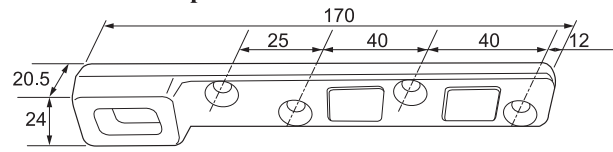

Drop forged steel, Zinc plated

9143TC(L) Offset top centre

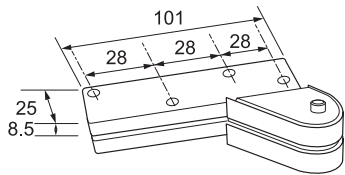

Drop forged steel, Zinc plated with stainless steel cover.

9143TC(R) Offset top centre

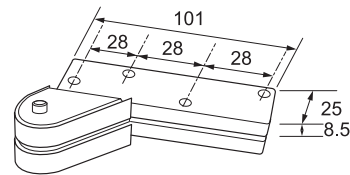

Drop forged steel, Zinc plated with stainless steel cover.

9143DS(L) Offset Door strap

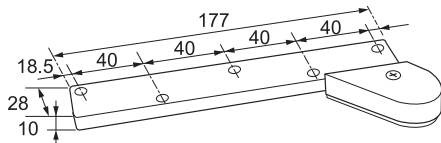

Drop forged steel, Zinc plated with stainless steel cover.

9143DS(R) Offset Door strap

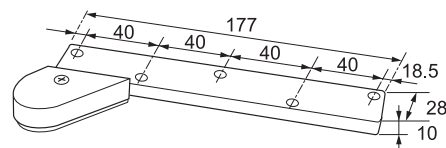

Drop forged steel, Zinc plated with stainless steel cover.

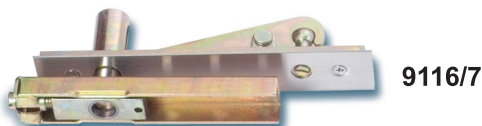

9116/7



9120/1

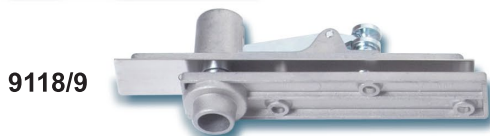

9118/9



9123



9143TC(L)



9143TC(R)

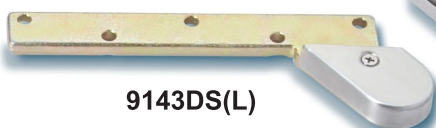

9143DS(L)

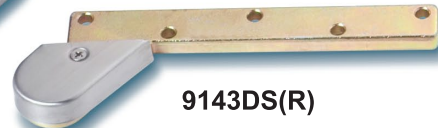

9143DS(R)

How To Order GCC Floor Spring

GTS 650-260SS

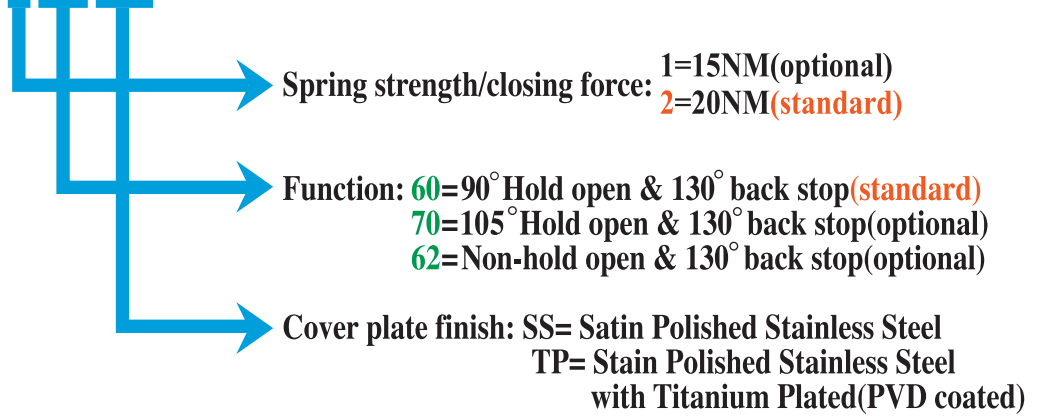

Note: Accessories must be ordered separately



Your product quality and safety mark, 500,000 cycles test approved Singapore Standard 332:2007:Annex F:-Clause 5.1 According to The test was conducted at TUV SUD PSB fire test laboratory singapore.



Unit 8/3 Selgar Ave
Clovelly Park, SA 5042
Phone: 0429 933 583
Email: sales@prestigeglassfittings.com.au
Web: www.prestigeglassfittings.com.au

Notes:

